

#### GENERAL CHARACTERISTICS

Nominal Overall Diameter .....	166	mm
Nominal Voice Coil Diameter .....	38	mm
Magnet Weight .....	98	g
Flux Density.....	1.42	T
Weight.....	1.03	Kg

#### THIELE-SMALL PARAMETERS

Voice Coil DC Resistance .....	$R_E$	6.16	Ω
Resonance Frequency .....	$f_s$	144.3	Hz
Mechanical Q Factor.....	$Q_{MS}$	2.93	
Electrical Q Factor.....	$Q_{ES}$	0.70	
Total Q Factor .....	$Q_{TS}$	0.57	
Mechanical Moving Mass .....	$M_{MS}$	9.9	g
Mechanical Compliance .....	$C_{MS}$	122	μm/N
Force Factor .....	$B \times l$	8.89	Wb/m
Equivalent Acoustic Volume.....	$V_{AS}$	2.6	lt.
Maximum Linear Displacement ....	$X_{MAX}$	+/-0.5	mm
Reference Efficiency .....	$\eta_0$	1.07	%
Diaphragm Area .....	$S_D$	122.7	cm <sup>2</sup>
Losses Electrical Resistance.....	$R_{ES}$	25.7	Ω
Voice Coil Inductance @ 1kHz .....	$L_E$	0.19	mH

#### CONSTRUCTIVE CHARACTERISTICS

Magnet.....	Neodymium
Voice Coil Winding.....	Aluminium
Voice Coil Former.....	Kapton
Cone .....	Paper
Surround.....	Treated Cloth
Dust Dome .....	Treated Cloth
Basket .....	Aluminium Die-Cast

#### ELECTRICAL CHARACTERISTICS

Nominal Impedance.....	8	Ω
Musical Power .....	200	W
Rated Power* .....	100	W
Sensitivity @ 1 W, 1 m .....	93.6	dB

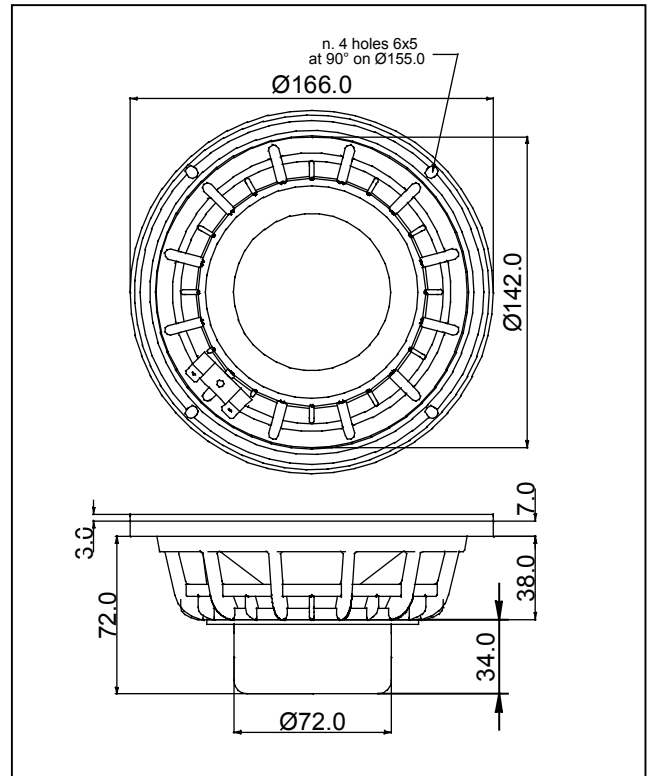

\*rated power measured with 2 hours test with pink noise signal, 6 dB crest factor, loudspeaker mounted on enclosure  
Thiele-Small parameters measured with LASER system

Frequency Response on IEC Baffle (DIN 45575) @ 1 W, 1 m - Free Air Impedance

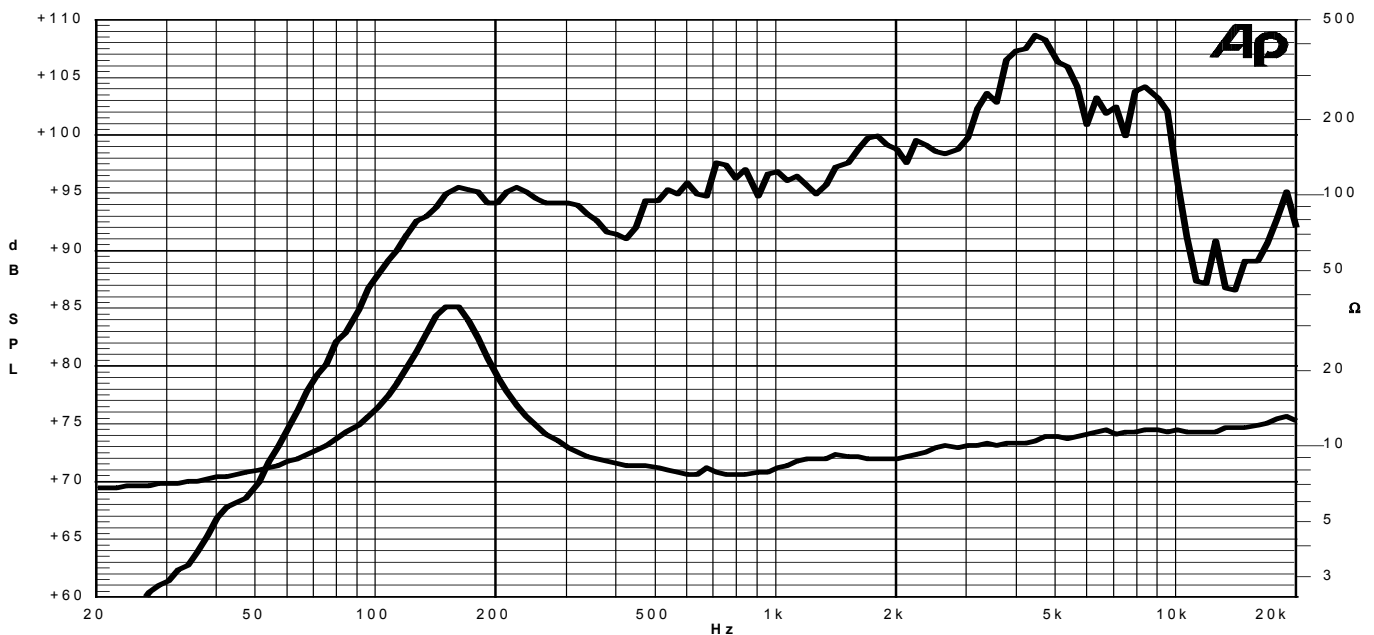

Due to continuing product improvement, the features and the design are subject to change without notice.

28/02/11